

COUNTY OF SAN JOAQUIN

DEPARTMENT OF PUBLIC WORKS
P.O. BOX 1810-1810 E. HAZELTON AVENUE
STOCKTON, CALIFORNIA 95201
(209) 468-3000
FAX # (209) 468-9324

Permit No: PS-1600331
Date Issued: 02/18/2016
Start Date: 02/18/2016
Exp. Date: 07/01/2016
Project No: PWP730052
Quad: SE

UE/CR/PM NO:31140031

ENCROACHMENT PERMIT

To: PACIFIC GAS & ELECTRIC - STOCKTON
PO BOX 930
STOCKTON, CA 95201

Encroachment Type:

Pole Replacement			
------------------	--	--	--

Location:

E/S OF SONORA RD. 3/4 MILE S/O HWY 4

In compliance with your request of **02/18/2016**, permission is hereby granted to do work in County right-of-way as shown on attached application and subject to all the terms, conditions and restrictions written below or printed as general or special provisions on any part of this form. See reverse side and attached sheet, if any.

Trench excavations for service connections will not be permitted within ten feet (10') of pavement centerline unless otherwise approved by the Director. Surface of trench patches shall match in kind and be smooth and even with that of abutting surface. Special attention shall be given to depth of utilities through roadside area in anticipation of future drainage facilities, road profile and/or frontage development. All underground utility facilities are to be established and accurately dimensioned on sketches from surveyed centerline of road right of way, or from right of way (border) lines.

Permittee shall call the Department of Public Works, Field Engineering Division (Permit Inspections) at (209)953-7421 at least forty-eight hours prior to beginning any work within the County right of way. All work performed under this permit shall conform to the rules and regulations pertaining to safety established by the California Division of Industrial Safety and Cal-OSHA.

The jobsite shall be kept in a safe condition at all times by the daily removal of any excess dirt or debris which might be a hazard to either pedestrian or automobile traffic. All necessary traffic convenience and warning devices and personnel shall be provided, placed and maintained by and at the sole expense of the Permittee in accordance with the latest edition of the CALTRANS Manual of Traffic Control.

After completion of the work permitted herein, all debris, lumber, barricades, or any excess material shall be removed and the jobsite left in a neat workmanlike manner. Immediately following completion of construction permitted herein, Permittee shall fill out and mail notice of completion (see attached post card) provided by Grantor.

Special Comments:

Traffic Control Per MUTCD

FORMS:

SS/WW, R-29		
-------------	--	--

Est. Permit Fee: \$824.00

WHITE -Permittee
GOLDENROD -PWD Central File
YELLOW -Field Inspection
PINK -Permit Section

KRIS BALAJI, Director
Department of Public Works

By: 
Permit Section

ENCROACHMENT PERMIT GENERAL PROVISIONS

13-1

1. This permit is issued under and subject to all laws and ordinances of agencies-governing the encroachment herein permitted. See the following references:

STREETS AND HIGHWAYS CODE

1. Division 1, Chapter 3
2. Division 2, Chapter 2, Section 942
3. Division 2, Chapter 4, Section 1126
4. Division 2, Chapter 5.5 and Chapter 6

SAN JOAQUIN COUNTY ORDINANCES NUMBERED: 324, 441, 648, 662, 672, 695, 700, 860, 892, 3359, and 3675.

2. It is understood and agreed by the Permittee that the performance of any work under this permit shall constitute an acceptance of all the provisions contained herein and failure on the Permittee's part to comply with any provision will be cause for revocation of this permit. Except as otherwise provided for public agencies and franchise holders, this permit is revocable on five days notice.
3. All work shall be done subject to the supervision of and the satisfaction of the grantor. The Permittee shall at all times during the progress of the work keep the County Highway in as neat and clean condition as is possible and upon completion of the work authorized herein, shall leave the County Highway in a thoroughly neat, clean and usable condition.
4. The Permittee also agrees by the acceptance of this permit to properly maintain any encroachment structure placed by the Permittee on any part of the County Highway and to immediately repair any damage to any portion of the highway, which occurs as a result of the maintenance of the said encroachment structure, until such time as the Permittee may be relieved of the responsibility for such maintenance by the County of San Joaquin.
5. The Permittee also agrees by the acceptance of this permit to make, at its own expense, such repairs as may be deemed necessary by the County Department of Public Works.
6. It is further agreed by the Permittee that whenever construction, reconstruction or maintenance work upon the highway is necessary, the installation provided for herein shall, upon request of the County Department of Public Works, be immediately moved or removed by and at the sole expense of the Permittee.
7. No material used for fill or backfill in the construction of the encroachment shall be borrowed or taken from within the County right of way.
8. All work shall be planned and carried out with as little inconvenience as possible to the traveling public. No material shall be stacked within eight feet (8') of the edge of the pavement or traveled way unless otherwise provided herein. Adequate provision shall be made for the protection of the traveling public. Traffic control standards shall be utilized including barricades; approved signs and lights; and flagmen, as required by the particular work in progress.
9. The Permittee, by the acceptance of this permit, shall assume full responsibility for all liability for personal injury or damage to property which may arise out of the work herein permitted or which may arise out of the failure of the part of the Permittee to properly perform the work provided under this permit. In the event any claim of such liability is made against the County of San Joaquin or any department, official or employee thereof, the Permittee shall defend, indemnify, and hold each of them harmless for such claim.
10. All backfill material is to be moistened as necessary and thoroughly compacted with mechanical means. If required by the County Director of Public Works, such backfill shall consist of gravel or crushed rock. The Permittee shall maintain the surface over structures placed hereunder as may be necessary to insure the return of the roadway to a completely stable condition and until relieved of such responsibility by the County Department of Public Works. Wherever a gravel, crushed rock or asphalt surface is removed or damaged in the course of work related to the permitted encroachment, such material shall either be separately stored and replaced in the roadway as nearly as possible in its original state or shall be replaced in kind, and the roadway shall be left in at least as good a condition as it was before the commencement of operations of placing the encroachment structure.
11. Whenever it becomes necessary to secure permission from abutting property owners for the proposed work, such authority must be secured by the Permittee prior to starting work.
12. The current and future safety and convenience of the traveling public shall be given every consideration in the location and methods of construction utilized.
13. The Permittee is responsible for the preservation of survey monuments located within the area of work herein permitted. Prior to the start of construction, survey monuments that potentially may be disturbed shall be located and referenced by a Licensed Land Surveyor, and a Corner Record filed with the County Surveyor. Any Survey Monuments disturbed during the course of construction shall be reestablished by a Licensed Land Surveyor and another Corner Record filed with the County Surveyor. (Land Surveyors' Act Section 8771)
14. Prior to any excavation, the Permittee shall notify USA North (Underground Service Alert of Northern California and Nevada) at 811 or 800-227-2600 forty-eight (48) hours in advance.

APPLICATION FOR ENCROACHMENT PERMIT

SAN JOAQUIN COUNTY

2015 DEC 30 PM 2:00

DEPT. OF PUBLIC WORKS

PLEASE PRINT:

Date 12-30-2015

To: San Joaquin County
Department of Public Works

PG&E Pm 31140031
(Applicant Name)

4040 West Lane
(Mailing Address)

Stockton CA 95204
(City, State, Zip Code)

(209) 373-9432
(Area Code - Telephone Number)

OFFICE USE ONLY

JOB #	<u>730052-6</u>	REF #	
APN		CR #	
EXP. DATE	<u>7/1/16</u>		
VALID	<u>2/18/16</u> TO <u>7/1/16</u>	DRIVEWAYS:	
STREET	<u>Sonora Rd</u>	*	
AREA	<u>Farmington QUAD SE</u>	*	
TYPE	<u>Pole Replacement</u>	*	
FORMS	<u>3/1/11</u>		
NOTES			

Sketch (Detailed plans may be submitted)

See Attached.

The undersigned hereby applies for permission to excavate, construct and/or otherwise encroach on County Highway Right-of-Way on the E side of Sonora Rd approximately 0.8 feet/mile S of CA Route 4, Farmington, by performing the following work (description of work):

Replace Pole. (Across From 27344 E Sonora Rd)

NOTE: replaces expired permit PS-1502650

Work will commence on or about 1-5-2016 for approximately 120 days.

I, the undersigned, certify that I am the owner of the respective property, or am qualified to represent the owner and agree to do the work described above in accordance with the rules and regulations of San Joaquin County and subject to inspection and approval.

R Davis
Signature of Applicant - Title

12-30-2015
Date

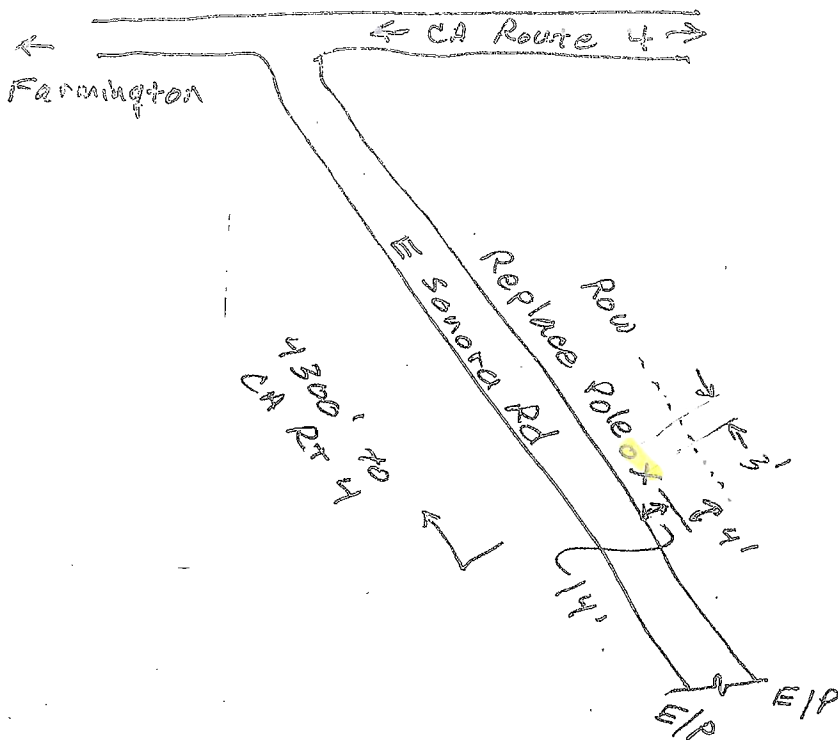
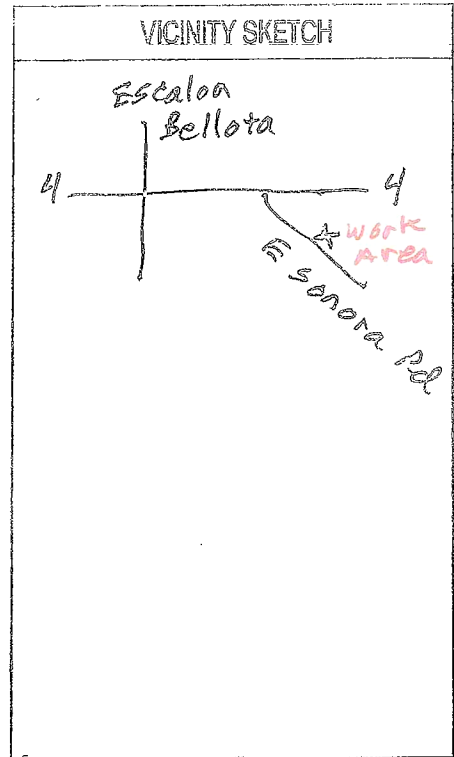

LEGEND

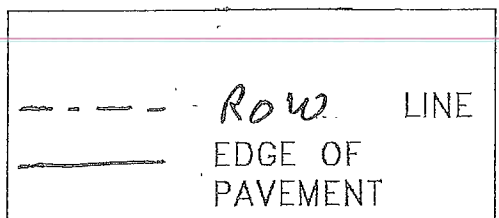

Pm 31140031

EST: ADAM VOGELAAR

ADE:

SUPV:

REP:

PLNR:

SCALE: DATE:

PERMIT SKETCH

REPLACE DETERIORATED POLE

N/E side E Sonora Rd 4300' S/E/O

CA R+4, Farmington

PACIFIC GAS AND ELECTRIC COMPANY



CO:

SD:

NOTIF:

OTHER:

SHT: 1 OF 1 SHEETS

PM:

3

REV.

4306'
to CA
R+4

capacitor pole



PM 31140031



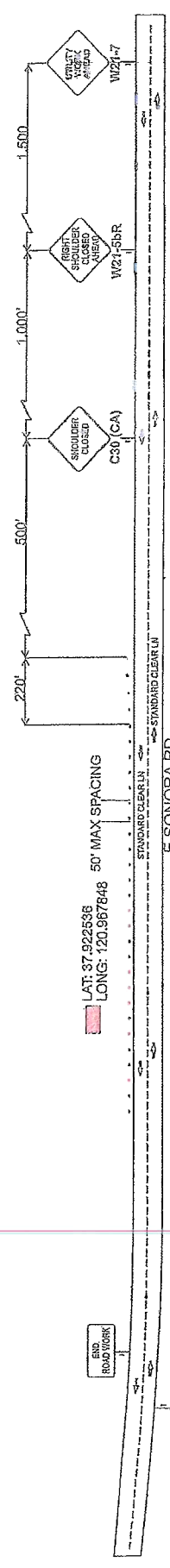

pm 31140031



LAT: 37.922538
LONG: 120.987848
50' MAX SPACING

END ROAD WORK

E SONORA RD

		CONTACT: WILLIAM ESCOBAR PHONE #: 951-327-0880	LOCATION: 27344 E. SONORA RD. FARMINGTON CONTRACTOR:	PLAN #2852 DATE: 9/8/2015	WORK ZONE W21-7 REFLECTIVE CONE TEMPORARY C.A.S. TRAFFIC FLOW G20-2	C30 (CA) W21-55R
	CONSTRUCTION HOURS: 7:00AM-5:00PM 50 MPH 10' OFFSET = 500' 11' OFFSET = 550' 12' OFFSET = 600'					

3114 0031

STATETWIDETM

TRAFFIC SAFETY & SIGNS



CONTACT:
WILLIAM ESCOBAR 925-327-0890

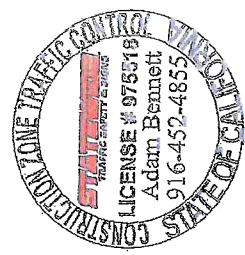

7920 CUCAMONCA AVE
SACRAMENTO, CA 95826
abenett@stcgsi.com
916-452-4855

OWNER SAN JOAQUIN COUNTY	ADDRESS/JOB NUMBER E SONORA RD, FARMINGTON, CA PM#31140031
LOCATION MAP	
E SONORA RD	
SPEED LIMIT 55	
COMPASS	

Statewide Traffic Safety and Signs ("Statewide") shall not be responsible for, and (PG&E & SAN JOAQUIN COUNTY) shall indemnify, defend and hold PG&E & SAN JOAQUIN COUNTY and its agents, representatives and employees from and against any claims, costs, damages, liabilities, expenses, demands and losses (including reasonable attorneys' fees and costs and expenses) arising out of or relating to the failure of any Traffic Control Plan applicable to Statewide's work or services (including any local, state or federal rule, regulation, ordinance, or statute, (PG&E & SAN JOAQUIN COUNTY) agrees that the Statewide is entitled to and will rely on the Traffic Control Plan(s) provided to Statewide by PG&E & SAN JOAQUIN COUNTY) and its agents, representatives and employees in the performance of Statewide's work or services.

GENERAL NOTES

- THIS PLAN SUPPLEMENTED WITH 2014 CA MUTCD.
- THE LOCATION OF THE SIGNS SHOWN ON THE PLAN ARE GUIDELINES AND ACTUAL LOCATIONS WILL DEPEND UPON THE LOCAL TRAFFIC ENGINEER'S DISCRETION.
- ALIGNMENT GRADE WILL BE CLOSER TO THE INTERSECTIONS AND THE 85TH PERCENTILE.
- ONLY ONE SIDEWALK WILL BE CLOSER TO THE INTERSECTIONS AND THE 85TH PERCENTILE.
- CA MUTCD STANDARD (SAC COUNTY 6-12-00 STANDARD CONSTRUCTION SPEC) SEE 2014 SAC DOT TEMPLATES TC-45 & TC-45.1
- NOTHING ALLOWED IN BUFFER/TRANSITION AREA AT ANY TIME.
- NOTIFY LOCAL LAW ENFORCEMENT, FIRE, AMBULANCE COMPANIES WITHIN 24 HOURS BEFORE CONSTRUCTION BEGINS.
- KEEP OPEN ACCESS FOR EMERGENCY VEHICLES AT ALL TIMES.
- SIGNS AND CHANNELIZING DEVICES MUST BE RETRO REFLECTIVE OR ILLUMINATE DURING THE NIGHT.
- MINIMUM TURNING RADIUS 1000'
- CONTINUOUS MONITORING AND MAINTENANCE OF THE TRAFFIC CONTROL ZONE WILL BE IMPLEMENTED FOR THE PURPOSE OF MAINTAINING EMERGENCY ACCESS, ACCESS FOR PEDESTRIANS, BICYCLE TRAFFIC AND THE DISABLED.
- ALL CONFLICTING MARKINGS ARE TO BE REMOVED FOR PROPOSED PROJECT AT TERM OF 3 DAYS OR LONGER.
- ALL SIGNS IMPLEMENTED WILL ONLY BE VIEWABLE WHEN IN USE. OTHERWISE ALL WARNING DEVICES WILL BE TAKEN DOWN OR COVERED.
- PROPER TRAINING OF TRAFFIC CONTROLLERS, PROPER DEVICES & PROPER USE OF THE DEVICES ARE REQUIRED AT ALL TIMES.

TABLE 1

APPROACH SPEED	* Min L	* Min L/S	Max SPACING OF LINES
15 MPH	11'	11'	11'
20 AND BELOW	15'	15'	15'
25	18'	18'	18'
30	22'	22'	22'
35	25'	25'	25'
40	28'	28'	28'
45	32'	32'	32'
50	35'	35'	35'
OVER 50	SEE NOTE 3	SEE NOTE 3	SEE NOTE 3

TABLE 2

APPROACH SPEED	Min D	Min D	DOWNGRADE Min D
15 MPH	11'	11'	11'
20 AND BELOW	15'	15'	15'
25	18'	18'	18'
30	22'	22'	22'
35	25'	25'	25'
40	28'	28'	28'
45	32'	32'	32'
50	35'	35'	35'
OVER 50	SEE NOTE 3	SEE NOTE 3	SEE NOTE 3

TABLE 3

ROAD TYPE	MINIMUM DISTANCE BETWEEN SIGNS
URBAN (SPEED 25 MPH OR LESS)	150'
URBAN (SPEED 30 MPH OR MORE)	350'
RURAL	500'
EXPRESSWAY / FREEWAY	SEE NOTE 3

ROAD TYPE	A	B	C
URBAN (LOW SPEED) 25 MPH OR LESS	100'	100'	100'
URBAN (LOW SPEED) MORE THAN 25 MPH TO 35 MPH	250'	250'	250'
URBAN (HIGH SPEED) MORE THAN 35 MPH TO 40 MPH	350'	350'	350'
RURAL	500'	500'	500'
EXPRESSWAY/FREEWAY USE 6C04 OF 2014 MUTCD	1,000'	1,000'	1,000'

LOW SPEED IS 10 MPH OR LESS
HIGH SPEED IS 45 MPH OR MORE
BOTH ARE BASED ON:
1. 85TH % TLE OR IF NOT AVAILABLE, THEN USE
2. POSTED SPEED LIMIT (PSL)
3. ANTICIPATED SPEED

L = TAPER LENGTH
S = SPEED
W = WIDTH (OFFSET FROM PATH OF TRAVEL)